

# Emergency nightlatches light

8764

## 8764 light sprung nightlatch with key lock-back

**ASSA ABLOY**

### Application:

Locks for exit doors offering a high degree of security, but with unrestricted exit in an emergency. Ideally suited for emergency doors in hotels, factories, hospitals, schools, offices etc.

Can be included as part of a total security system, including mechanical and electrical devices. Striking plate is included. Cylinder and accessories bolt through lockcase for added strength. Key can only be removed in locked (or locked-back) position.

Bolt reversible without opening lockcase.

For finishes and dimensions see Lockcases Information appendix. For accessory configurations see Variations insert.

When ordering please specify door thickness.

### Specification:

Bolt deadlocks automatically when door is closed but with special faceplate key for locking bolt into lockcase. Ideal where security is not required whilst building is fully occupied (e.g. office hours). Light spring for use with turn. Available with either 50mm or 70mm backset.

May be converted by Stockists to operate with snib lock-back.

### Finish:

Product has been successfully type-tested for conformity to BS EN 12209.

Regular audit testing is undertaken.



### Standards:

#### Microswitching

An internal microswitch can be fitted in any of these locks to enable an alarm or other signal to be activated by use of either the escape function or key and escape function.

ME = Microswitch to signal use of emergency facility or handle.

MK = Microswitch to signal use of key and emergency facility/handle.

Example Ref: 8760 (lock) / 70mm (backset) / LH outward (handing) / 4801 (cylinder) / Var 3 (emergency variation / ME (microswitch) i.e. 8760 / 70mm / LH outwards / 4801 / var 3 / ME.

#### Microswitch Details:

Red: Common  
Blue: Normally Open  
Yellow: Normally Closed

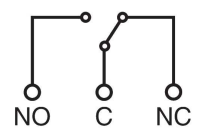

Single Pole Double Throw. Maximum power rating 2A at 24V DC.

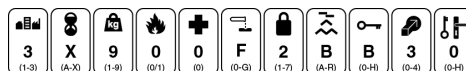

# Emergency nightlatches light

**ASSA ABLOY**

8764

8764 light sprung nightlatch with key lock-back

## Technical Design:

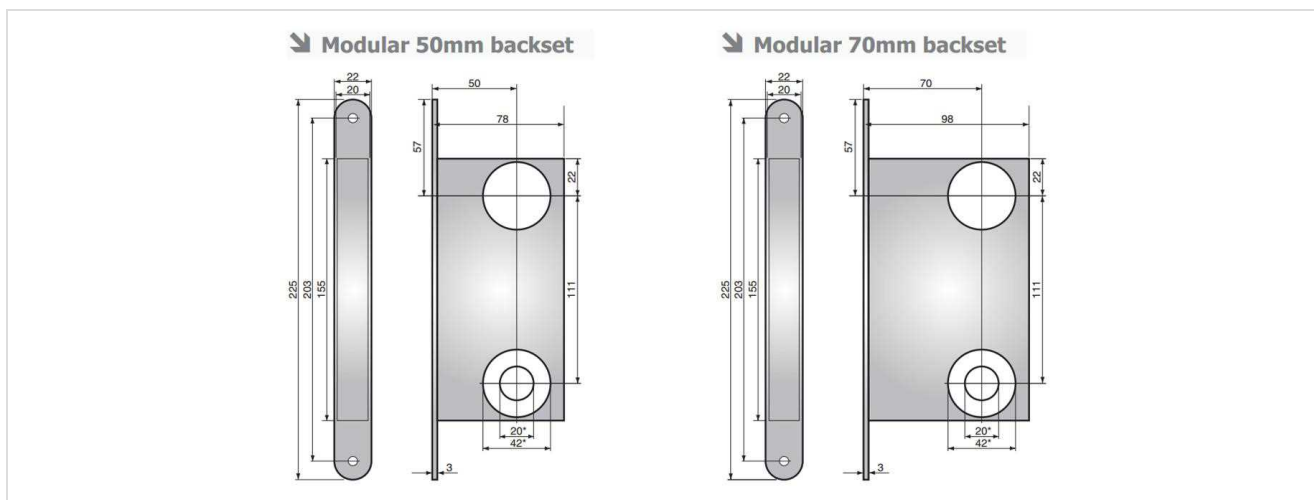

## Variants:

Code	Description
80408262313	8764 50MM LOCKSET
80407962313	8764 70MM LOCKSET